



**L-320CN
EYE HOOK**



**L-320C
EYE HOOK**

All Crosby L-320 Eye Hoist Hooks incorporate the following features:

- The most complete line of Eye hoist hooks.
- Available in carbon steel and alloy steel.
- Designed with a 5:1 Design Factor for (Carbon Steel); 4.5:1 Design Factor for 30t - 60t (Alloy Steel).
- Eye hooks are load rated.
- Proper design, careful forging and precision controlled quenched and tempering give maximum strength without excessive weight and bulk.
- Every Crosby Eye Hook is equipped with a latch. Even years after purchase of the original hook, latch assemblies can be added. (See pages 121 - 123)
- Chemical analysis and tensile tests performed on each PIC to verify chemistry and mechanical properties.
- Type Approval certification in accordance with ABS 2016 Steel Vessel and Guide for Certification of Lifting Appliances 2016 available. Certificates available when requested at time of order and may include additional charges.
- Meets ASME B30.10
- Hoist hooks incorporate two types of strategically placed markings forged into the product which address two (2) **QUIC-CHECK®** features:
- Deformation Indicators and Angle Indicators (see following page for detailed definition)

The following additional features have been incorporated in the new Crosby L-320N Eye Hoist Hooks. (Sizes 3/4 metric ton Carbon through 22 metric ton Alloy.)

- Metric Rated at 5:1 Design Factor for (Carbon Steel); 5:1 Design Factor for 1t - 22t (Alloy Steel).
- Can be proof tested to 2 times the Working Load Limit.
- Low profile hook tip
- New integrated latch (S-4320) meets the world-class standard for lifting.
 - Heavy duty stamped latch interlocks with the hook tip.
 - High cycle, long life spring.
 - When secured with proper cotter pin through the hole in the tip of hook, meets the intent of OSHA Rule 1926.1431(g) and 1926.1501(g) for personnel hoisting.

Load Rated

Fatigue Rated



QUIC-CHECK®



L-320N / L-320 EYE HOOKS

Working Load Limit (t)		Hook ID Code	Eye Hook Stock No.			Weight Each (lb)	Replacement Latch Kits		
Carbon	Alloy		Carbon L-320C L-320CN S.C.	Carbon GL-320CN Galv.	Alloy L-320A L-320AN S.C.		S-4320 Stock No.	PL Stock No.	SS-4055 Stock No.
3/4	1	†D	1022205	1022208	1022380	.61	1096325	-	-
1	1-1/2	†F	1022216	1022219	1022391	.89	1096374	-	-
1-1/2	2	†G	1022227	1022230	1022402	1.44	1096421	-	-
2	3	†H	1022238	1022241	1022413	2.07	1096468	-	-
3	5	†I	1022246	1022249	1022424	4.30	1096515	1092000	-
5	7	†J	1022260	1022262	1022435	8.30	1096562	1092001	-
7-1/2	11	†K	1022271	1022274	1022446	15.00	1096609	1092002	-
10	15	†L	1022282	1022285	1022457	20.77	1096657	1092003	-
15	22	†N	1022293	1022296	1022468	39.50	1096704	1092004	-
20	30	O	1022302	-	1022477	60.00	-	1093716	1090161
25	37	P	1023306	-	1023565	105.00	-	1093717	1090189
30	45	S	1023324	-	1023583	148.00	-	1093718	1090189
40	60	T	1023342	-	1023609	228.00	-	1093719	1090205

*Eye Hooks (3/4 TC - 22TA), Proof load is 2 times Working Load Limit. Eye Hooks (20 TC - 60TA). All carbon hooks-average straightening load (ultimate load) is 5 times Working Load Limit. Alloy eye hooks 1 ton through 22 ton-average straightening load (ultimate load) is 5 times Working Load Limit. Alloy eye hooks 30 tons through 60 tons-average straightening load (ultimate load) is 4.5 times Working Load Limit. † New 320N style hook.



S-377
BARREL HOOKS

- Forged Carbon Steel - Quenched and Tempered.
- Meets the performance requirements of Federal Specification RR-C-271G, Type V, Class 6, except for those provisions required of the contractor.



S-377 Barrel Hooks

Working Load Limit Per Pair (Tons)*	S-377 Stock No. Per Pair	Weight Each Per Pair (lb)	Dimensions (in)			
			I.D. of Eye	O.D. of Eye	Overall Length	Width of Lip
1	1028248	3.56	1.56	2.81	5.00	2.88

*Ultimate Load is 4 times the Working Load Limit.



S-3316
REPLACEMENT HOOK

- Easily attaches to any chain and electric hoist with welded link load chain, roller chain or wire rope with suitable end fitting
- Swivel jaw is forged.
- Suitable for infrequent, non-continuous rotation under load.
- Use in corrosive environment requires shank and nut inspection in accordance with ASME B30.10-1.10.4(b)(5)(c).

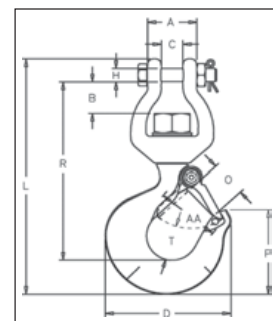

Load Rated®



S-3316 Replacement Hook

Working Load Limit (Tons)*	Frame Code	S-3316 Stock No.	Weight Each (lb)	Dimensions (in)										Replacement Latch Kit Stock No.
				A	B	C	D	H	L	O	P	R	T	
1/2	F	1023029	1.25	1.31	.76	.56	3.19	.38	6.12	.97	2.25	4.59	.81	1096374
1	H	1023047	2.61	1.56	1.00	.69	4.09	.44	7.69	1.12	2.84	5.81	1.19	1096468

*Ultimate Load is 5 times the Working Load Limit.



A-378
SORTING HOOK

- Forged Alloy Steel - Quenched and Tempered.
- Deep straight throat permits efficient handling of flat plates or large cylindrical shapes.



A-378
SORTING HOOK

A-378 Sorting Hook

Working Load Limit at tip of Hook (Tons)*	Working Load Limit at bottom of Hook (Tons)*	A-378 Stock No	Style	Weight Each (lb)	Dimensions (in)			
					I.D. of Eye	Overall Length	Opening at top of Hook	Radius at bottom of Hook
2	7-1/2	1028024	No Handle	6.42	1.38	9.69	2.81	.625
2	7-1/2	1028033	With Handle	6.42	1.38	9.69	2.81	.625

*Ultimate Load is 4 times the Working Load Limit.

Crosby® SHUR-LOC® Hooks



**S-1326
SWIVEL HOOK**

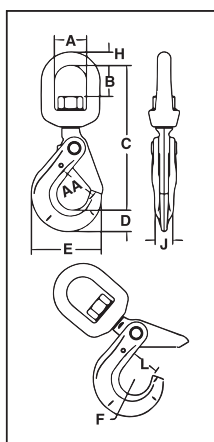

- Forged Alloy Steel - Quenched and Tempered.
- Individually Proof Tested at 2-1/2 times the Chain Working Load Limit with certification
- Recessed trigger design is flush with the hook bod , protecting the trigger from potential damage.
 - Easy to operate with enlarged thumb access.
- Positive Lock Latch is Self-Locking when hook is loaded.
- Rated for both Wire Rope and use with Grade 80/100 Chain or G-411 Standard Th
- G-414 Heavy Thimble or G-411 Standard Thimble should be used with wire rope slings.
- Trigger Repair Kit available (S-4316). Consists of spring, roll pin and trigger.
- S-13326 Swivel Hook utilizes anti-friction bearing design which allows hook to rotate freely under load.
- Fatigue rated.
- The SHUR-LOC® hook, if properly installed and locked, can be used for personnel lifting applications and meets the intent of OSHA Rule 1926.1431(g)(1)(i)(A) and 1926.1501(g)(4)(iv)(B).
- "Look for the Platinum Color – Crosby Grade 100 Alloy Products."



Crosby 8/10™



Fatigue Rated



Use in corrosive environment requires shank and nut inspection in accordance with ASME B 30.10-1.10.4 (b)(5)(c) 2019. The S-1326 hook is a positioning device and is not intended to rotate under load. For swivel hook designed to rotate under load, use the S-13326.



**S-13326
SWIVEL HOOK
with BEARING**

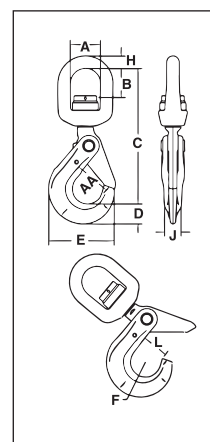

S-1326 SHUR-LOC® Swivel Hooks • Suitable for infrequent, non-continuous rotation under load.

Chain Size		Frame code	Grade 100 Alloy Chain Working Load Limit (lb) 4:1*	Working Load Limit (lb) 5:1*	S-1326 Stock No.	Weight Each (lb)	Dimensions (in)									
(in)	(mm)						A	B	C	D	E	F	H	J	L	AA**
-	6	D	3200	2560	1004304	1.26	1.50	1.32	6.13	.79	2.60	.67	.50	.63	1.13	1.50
1/4 - 5/16	7-8	G	5700	4560	1004313	2.62	1.75	1.59	7.60	1.10	3.50	.87	.63	.81	1.38	2.00
3/8	10	H	8800	7040	1004322	4.70	2.00	1.73	8.83	1.17	4.39	1.10	.75	.94	1.75	2.50
1/2	13	I	15000	12000	1004331	8.64	2.50	2.38	11.20	1.67	5.45	1.26	1.00	1.16	2.11	3.00
5/8	16	-	22600	18000	1004340	17.00	2.75	2.70	12.90	2.05	6.56	1.50	1.13	1.50	2.49	3.50
3/4	18 - 20	-	35300	28240	1004349	24.00	2.83	2.52	14.10	2.22	7.76	2.01	1.10	2.03	3.52	5.00
7/8	22	-	42700	34160	1004358	29.00	3.44	3.19	16.40	2.45	8.75	2.26	1.30	2.20	3.83	6.00

*Ultimate Load is 4 times the Working Load Limit. ** Deformation Indicators.

S-13326 SHUR-LOC® Swivel Hooks with Bearing • Suitable for frequent rotation under load.

Chain Size		Frame code	Grade 100 Alloy Chain Working Load Limit (lb) 4:1*	Working Load Limit (lb) 5:1*	S-13326 Stock No.	Weight Each (lb)	Dimensions (in)									
(in)	(mm)						A	B	C	D	E	F	H	J	L	AA**
-	6	D	3200	2560	1004404	1.50	1.50	1.14	6.17	.79	2.60	.67	.50	.63	1.13	1.50
1/4 - 5/16	7-8	G	5700	4560	1004413	3.10	1.75	1.52	7.54	1.10	3.50	.87	.63	.81	1.44	2.00
3/8	10	H	8800	7040	1004422	5.26	2.00	1.61	8.88	1.16	4.35	1.10	.75	.94	1.83	2.50
1/2	13	I	15000	12000	1004431	11.22	2.50	2.03	11.11	1.66	5.45	1.26	1.00	1.16	2.19	3.00
5/8	16	-	22600	18000	1004440	17.32	2.75	2.25	12.90	2.05	6.56	1.50	1.13	1.50	2.61	3.50

* Ultimate Load is 4 times the Working Load Limit. ** Deformation Indicators.



L-322CN / L-322AN
(L-322AN Shown)

- Forged - Quenched and Tempered.
- Swivel hooks are load rated.
- Proper design, careful forging, and precision controlled quench and tempering gives maximum strength without excessive weight and bulk.
- Low profile hook tip designed to utilize Crosby S-4320 or PL-N latch kit. Simply purchase the latch assemblies listed and shown on pages 121 - 122. Even years after purchase of the original hook, latch assemblies can be added.
- Hoist hooks incorporate markings forged into the product which address two (2) **QUIC-CHECK®** features:
 - **Deformation Indicators** -- Two strategically placed marks, one just below the shank or eye and the other on the hook tip, which allows for a QUIC-CHECK® measurement to determine if the throat opening has changed, thus indicating abuse or overload.
 - **Angle Indicators** — Indicates the maximum included angle which is allowed between two (2) sling legs in the hook. These indicators also provide the opportunity to approximate other included angles between two sling legs.
- Type Approval certification in accordance with ABS 2016 Steel Vessel Rules and ABS Guide for Certification of Lifting Appliances 2016 available. Certificates available when requested at time of order and may include additional charges.

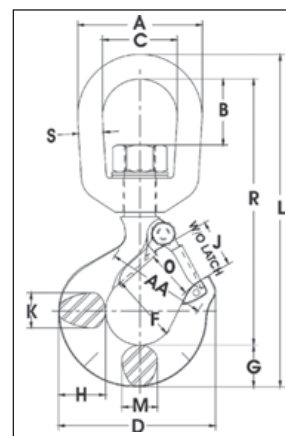

Load Rated

Fatigue Rated



Suitable for infrequent, non-continuous rotation under load. Use in corrosive environment requires shank and nut inspection in accordance with ASME B30.10-1.10.4(b)(5)(c).

L-322CN & L-322AN Swivel Hooks

Working Load Limit (t)*		Hook ID Code*	L-322CN Stock No.	L-322AN Stock No.	Weight Each (kg)	Dimensions (mm)														Rep. Latch Stock No.	
Carbon	Alloy					A	B	C	D	F	G	H	J	K	L	M	O †	R	S		AA**
.75	1.25	D	1048603	1048807	.34	51.0	20.8	31.8	72.5	31.8	18.5	20.6	23.6	16.0	144	16.0	23.6	116	9.65	38.1	1096325
1	1.60	F	1048612	1048816	.57	63.5	33.3	38.1	80.0	35.1	21.3	23.9	24.6	18.0	170	18.0	24.6	136	12.7	50.8	1096374
1.6	2.50	G	1048621	1048825	1.02	76.0	38.1	44.5	91.0	38.1	25.4	29.5	26.9	22.4	197	22.4	26.9	155	16.0	50.8	1096421
2	3.20	H	1048630	1048834	1.04	76.0	38.1	44.5	102	41.1	28.7	33.3	30.2	23.9	210	23.9	29.5	165	16.0	50.8	1096468
3.2	5.4	I	1048639	1048840	2.25	89.0	41.7	50.8	123	51.0	36.6	41.4	38.1	33.3	246	28.7	35.8	191	19.1	63.5	1096515
5	8.0	J	1048648	1048859	4.67	116	58.0	63.5	160	63.5	46.0	52.5	45.2	42.2	317	36.6	42.9	245	25.4	76.2	1096562
7.5	11.5	K	1048657	1048868	8.80	127	62.0	70.0	192	76.0	57.0	67.0	51.0	47.8	375	41.4	56.5	289	28.7	101	1096609
10	16	L	1048666	1048880	10.5	143	63.0	79.0	212	82.5	66.0	74.5	66.5	55.5	417	49.3	61.0	311	31.8	101	1096657
15	22	N	1048675	1048889	21.3	180	95.5	104	263	108	76.0	89.0	86.5	68.5	542	60.5	81.0	424	38.1	127	1096704
-	31.5	O	-	1048898	32.0	180	95.5	104	346	127	93.0	118	102	72.5	590	76.2	82.6	459	38.1	165	1090161

* Carbon swivel hooks .75tC-15tC: proof load is 2 times working load limit. Designed with a 5 to 1 safety factor. Alloy swivel hooks 1tA - 30tA : proof load is 2.5 times working load limit. Designed with a 4 to 1 safety factor. Alloy swivel hook 30tA: proof load is 2 times working load limit. Designed with a 4 to 1 design factor. ** Deformation Indicators † Dimensions for hooks 3/4t carbon thru 22t alloy are for S-4320 latch kits. Dimensions for hooks 30t alloy are for 4055 latch kit.