

Harrington CF hand chain hoists give you a practical alternative thanks to an economical design using fewer parts for trouble-free service. Outstanding durability is due to a die-cast aluminum body and high-strength, heat-treated main pinion shaft and load gear. Pre-lubricated ball bearings, precision machined gears, and Weston-style load brake mak lifting smooth and easy while allowing long service and low maintenance.

### Many Benefits from More Features:

- Experience exceptional strength with a thick die-cast aluminum body.
- Handle tough demands with high-strength, heat-treated main pinion shaft and load gear.
- Get positive braking action with Weston-style load brake incorporating two moisture-resistant brake pads with four braking surfaces.
- Minimize manual effort thanks to smooth running, pre-lubricated ball bearings, and precision machined drive train components.
- Simplify maintenance with fewer parts and an easy-to-work-on design.

### Capabilities to Count On:

- 10-foot lift is standard, 15- and 20-foot lifts are also stocked; nonstandard lifts and hand chain drops available as well.
- Grade 100 heat-treated manganese alloy load chain resists abrasion and wear while minimizing chain weight.
- Forged and heat-treated alloy steel hooks are designed to open slowly and not fracture under excessive loads.
- Test certificate verifies that every hoist has been factory load tested to 125% of rated capacity, in accordance with ASME B30.16 requirements.

### Options:

- Chain container
- Corrosion-resistant chain
- Inspection hook

### CF Hand Chain Hoist - Dimensions

Cap. (Tons)	Product Code	a (in)	b (in)	d (ft)	e (in)	f (in)	g (in)
1/2	CF005	5.4	5.9	10	2.0	2.4	1.1
1	CF010	5.8	6.9	10	2.3	2.9	1.1
1-1/2	CF015	6.0	8.0	10	2.4	3.4	1.3
2	CF020	5.8	8.0	10	2.3	2.3	1.4
3	CF030	6.0	9.4	10	2.4	2.7	1.7
5	CF050	6.0	13.5	10	2.4	4.5	1.8

### CF Hand Chain Hoist - Specifications

Cap. (Tons)	Product Code	Headroom C (in)	Std. Lift (ft)	Pull to Lift Load (lbs)	Overhaul Ratio	Load Chain Diameter (mm) x Chain Fall Lines	Net Weight (lbs)	Shipping Weight Approx. (lbs)	Weight for Additional One Foot of Lift (lbs)
1/2	CF005	12.8	10	60	19	5.0 X 1	24	26	1.0
1	CF010	14.6	10	72	31	6.3 X 1	29	31	1.2
1-1/2	CF015	17.3	10	84	41	7.1 X 1	40	42	1.4
2	CF020	20.1	10	80	63	6.3 X 2	47	49	1.8
3	CF030	23.2	10	92	81	7.1 X 2	62	66	2.1
5	CF050	24.4	10	92	134	7.1 X 3	82	86	2.9

Please Note: Special lengths of load and hand chain available upon request. Weights are approximate.

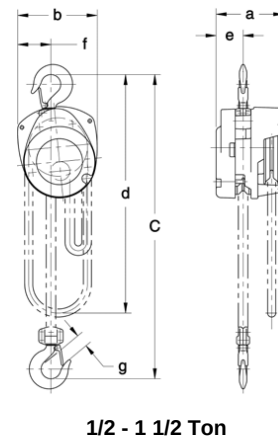

1/2 - 1 1/2 Ton

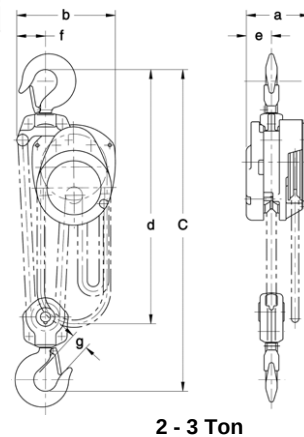

2 - 3 Ton

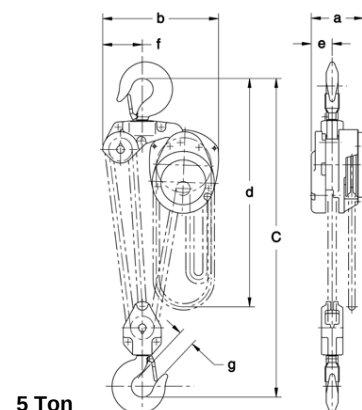

5 Ton